



How to Play the Action for Nature Garden Race game.

You will need.

- Colour printer.
- Glue or Cello tape.
- Match Sticks.
- Blue Tack
- Paper and Card.

Print out the game board, question cards and playing pieces.

Cut out the playing pieces and die and glue to thin card.

Push a pencil through the centre of the die and fold the playing pieces so that they will stand up.

Cut out the question cards. These can be glued to thin card.

Cut out the Garden Notice boards and glue them to thin card. Stick a match stick to the back of the card to make a central post for each notice board and then stick on to the game board at the appropriate square with a blob of blue tack.

You may like to stick the game board to a sheet of cardboard.

Each player picks a playing piece to use and places it on the door mat of the house.

The question cards are shuffled and placed face down on the table.

The race is to the statue in the middle of the garden following the numbered track.

Spin the die for who goes first. Highest goes first.

That player then spins the die for the number of squares his counter moves.

The person to the left takes a card from the deck and reads out the question with the same number as that the player rolled. If the player gets the answer right he stays where he is if not he moves back one square.

The player then has to carry out any instructions written on the Garden Notice board if one is present on his square.

The Pond must be cleared in one go. If a move will not clear the pond the player stays on square 38.

The Frog is the only player who ignores the pond and swims across.

It is now the turn of the next player to spin the die and the process is repeated.

START

1 2 3 4 5 6 7 8 9 10

11

12

13

14

15

16

17

18

19

20

21

22

23

24

25

26

27

28

29

30

31

32

33

34

35

36

37

38

63

62

61

60

59

58

57

56

55

54

53

52

51

50

49

48

47

46

45

44

43

42

41

40

39

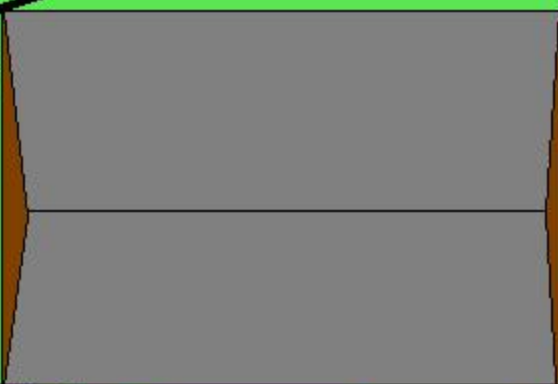
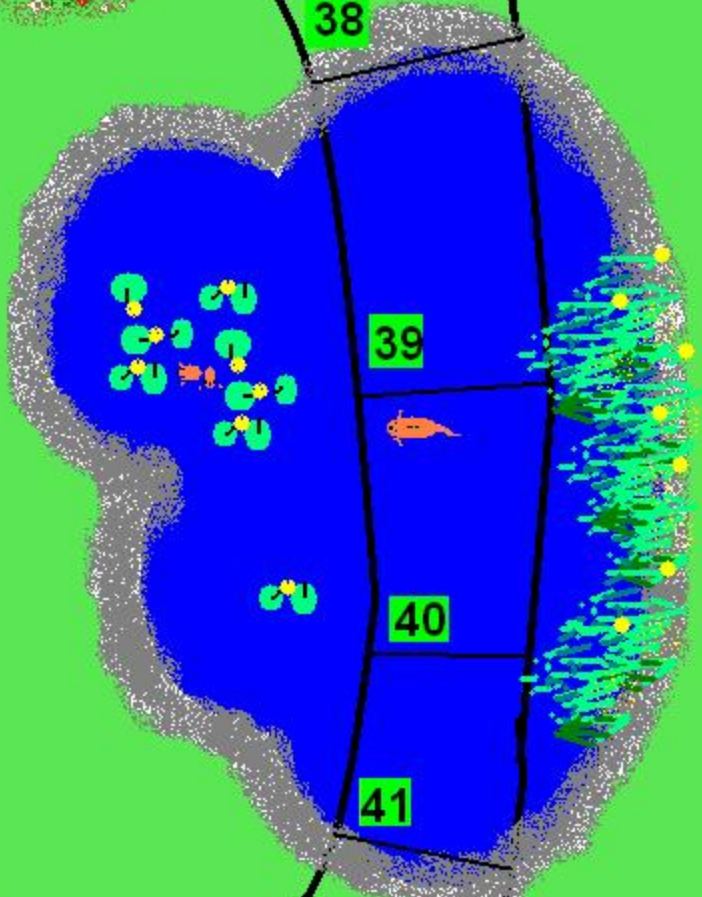
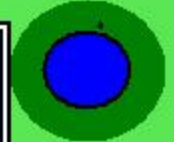
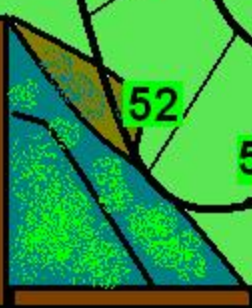
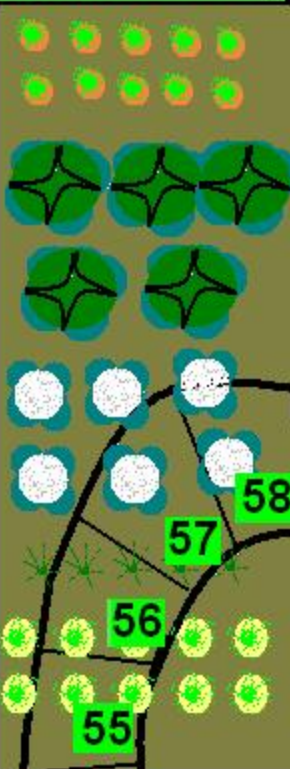
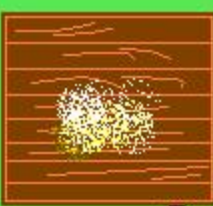

Game Notice Boards

Square 13

Tool Shed

Short cut

Go To Square 35

Square 19

Bird Bath

Short cut

Go To Square 26

Square 39-41

Pond Leap

Go back to

square 38

unless you are Frog

Square 46

Habitat Pile

Frog / Hedgehog

Miss 1 Turn

Square 52

Compost Heap

Worm / Frog

Miss 1 Turn

Square 57

Vegetable Patch

Snail

Miss 1 Turn

Square 23

Bird Table

Robin

Miss 1 Turn

Square 8

Flower Bed

Ladybird

Miss 1 Turn

Game Counter

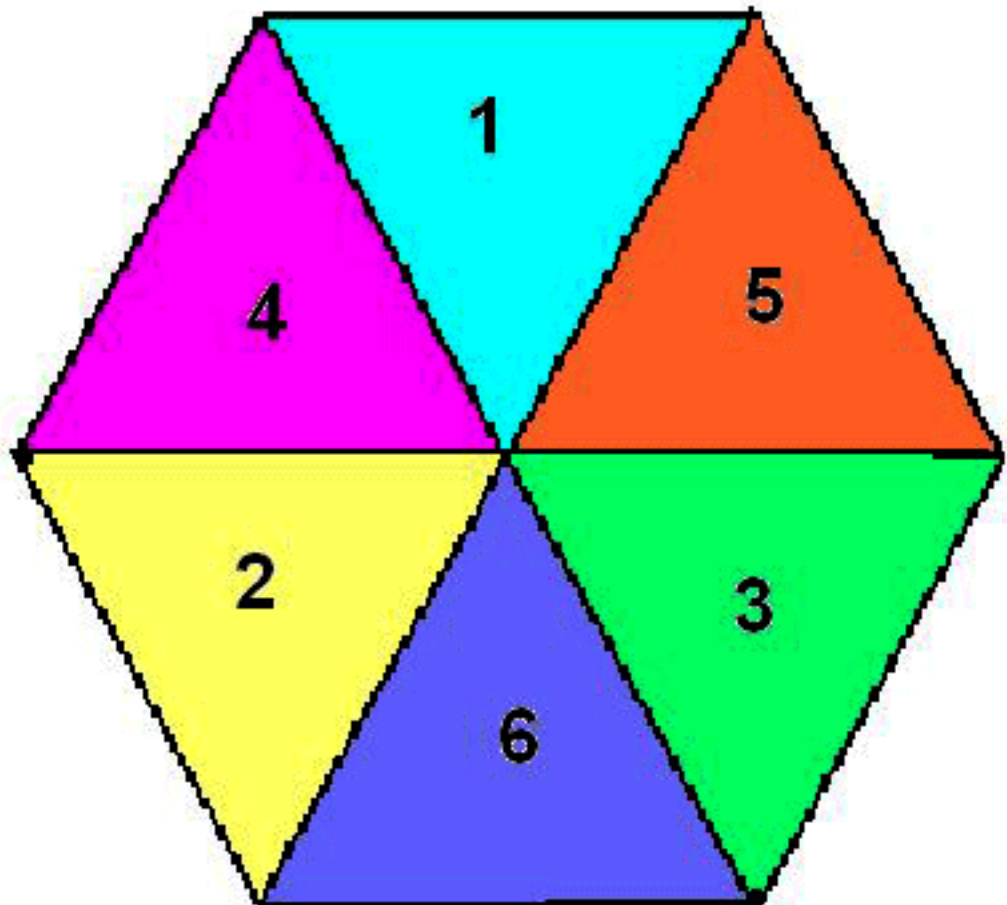
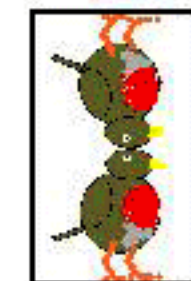
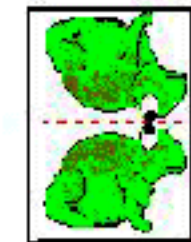
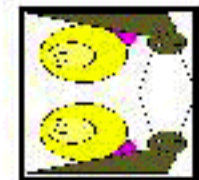
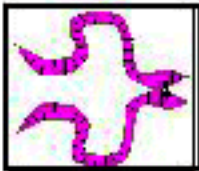



Games Questions

1. What colour is a Buttercup? (**Yellow**).
 2. How do you spell **FROG**?
 3. What colour is a Poppy? (**Red**).
 4. Where would you find a Bluebell? (**In a Wood**).
 5. Do Hollies lose there leaves in autumn? (**NO**).
 6. Do nettles sting? (**Yes**).
-

1. What do snails have on their backs? (**A shell**).
2. What colour is a male robins chest? (**Red**).
3. What colour is a fox? (**Red**).
4. How many legs does a bird have? (**Two**).
5. What are birds claws called? (**Talons**).
6. How many eyes does an ant have? (**Two**)



Games Questions

1. How many legs does an ant have? (**Six**).
 2. Can bats fly? (**Yes**).
 3. When do badgers come out? (**At Dusk**).
 4. Are hedgehogs smooth? (**No**).
 5. Do bees sting? (**Yes**).
 6. What insects make honey? (**Bees**).
-

1. Do ants live in a nest? (**Yes**).
2. What do caterpillars change into? (**A Butterfly**).
3. Where do acorns come from? (**Oak Trees**).
4. What colour is grass? (**Green**).
5. What are frogs eggs called? (**Frog Spawn**).
6. What do spiders spin? (**Webs**). Silk



Games Questions

1. Can some spiders live in water? (**Yes**).
 2. How many legs does a spider have? (**Eight**).
 3. Where do worms live? (**In soil**).
 4. How do you spell **WASP**?
 5. What do spiders eat? (**Flies**).
 6. What is a baby Rabbit called? (**A kitten**).
-
1. What is a baby frog called? (**A Tadpole**).
 2. Where do ducks live? (**In a Pond**).
 3. What noise do ducks make? (**Quack**).
 4. What colour is a swan? (**White**).
 5. What's a female swan called? (**pen**)
 6. What is a male swan called? (**A cob**).



Games Questions

1. Where does a kingfisher nest (**in a Burrow**).
 2. Where does a Woodpecker live? (**In a Tree**).
 3. .Can a kingfisher dive? (**Yes**).
 4. Are bats blind? (**No**)
 5. Do bats hibernate? (**Yes**).
 6. Do squirrels hibernate? (**No**).
-
1. Where do bees live? (**In a Hive**).
 2. What do bees feed on? (**Nectar**).
 3. Do Kestrels Hover? (**Yes**).
 4. Do Humming birds hover? (**Yes**).
 5. What is a Badgers home called? (**A Sett**).
 6. What is a Rabbits home called? (**A Burrow**)



Games Questions

1. What do tadpoles change into? (**Frogs**).
 2. Where does wood come from? (**Trees**).
 3. What is paper made from? (**Trees**).
 4. Does a snake shed its skin? (**Yes**).
 5. Do Insects shed their skin? (**Yes**).
 6. Where do frogs lay their frogspawn? (**In a pond**).
-
1. What colour are cornflowers? (**Blue**).
 2. Do squirrels eat nuts? (**Yes**).
 3. What must you NOT leave in the countryside? (**Litter**).
 4. Are amphibians invertebrates? (**No**).
 5. What is the most common small bat in Britain? (**The Pipistrelle**).
 6. How many legs does a frog have? (**Four**).



Games Questions

1. What colour is a blue tits chest? (**Yellow**).
 2. Are brambles thorny? (**Yes**).
 3. What does a rose have on its stem? (**Thorns**).
 4. What do bees make honey with? (**Nectar**).
 5. What is made from Pollen? (**Royal Jelly**).
 6. What has branches? (**A tree**).
-

1. What colour are the berries on holly? (**Red**).
2. What colour are the berries on mistletoe? (**White**).
3. What colour is a forget me not? (**Blue**).
4. What colour is Ivy? (**Green**).
5. How do you spell **HEDGEHOG**?
6. What is the berry from the bramble called? (**Blackberry**).



Games Questions

1. Which is Britain's tallest tree? (**Scotch pine**).
 2. Do otters fish at night? (**Yes**).
 3. How many types of red ladybird are there? (**Two**).
 4. What are the two types of ladybird? (**Seven spots & two Spots**).
 5. Where do honey bees store honey? (**In a comb**).
 6. Where do honeybees keep their young? (**In a wax cell**).
-

1. Does the common toad hibernate? (**Yes**).
2. Do frogs croak? (**Yes**).
3. What is a leveret? (**Baby hare**).
4. What do squirrels bury in the autumn? (**Nuts**).
5. Do swallows migrate for the winter? (**Yes**).
6. What is a male rabbit called? (**A buck**).



Games Questions

1. What's the name of the trees that don't lose their leaves in winter?
(**Evergreen**).
 2. What do ladybirds eat? (**Aphids**).
 3. What insect do ants eat? (**Aphids**).
 4. What is butterflies favourite shrub? (**Buddleia**).
 5. What insects row across a pond? (**Water boatmen**).
 6. What is the natural diet of a hedgehog? (**Slugs & Insects**).
-

1. Why should slug pellets not be used in the garden?
(**They poison hedgehogs**).
2. Which plant is known as knit bone? (**Comfrey**).
3. What large waterside plant is poisonous if touched? (**Giant hogweed**)
4. What do Long Tailed Tits use to line their nests? (**Moss & spiders webs**).
5. Which discarded fishing material is harmful to ducks? (**Fishing line**).
6. Can birds dive under the water? (**Yes**)



Games Questions

1. What flying mammal roosts in the lofts of houses? (**A bat**).
 2. What is the largest type of newt in Britain? (**The great crested newt**).
 3. Is a slow worm a snake? (**No**).
 4. What is the most common garden snake? (**grass snake**).
 5. What native hedgerow shrub flowers in May? (**Hawthorn**).
 6. What a squirrel's house called? (**A drey**).
-

1. What common bird of prey hovers? (**A kestrel**).
2. Which type of wood is used to make Cricket Bats? (**Willow**).
3. How do bats find their way around in the dark? (**Sounds**).
4. What yellow spring flower has a trumpet? (**A daffodil**).
5. How many wings does a dragonfly have? (**four**).
6. Where do Hedgehogs live? (**In a nest**).



Games Questions

1. Can hedgehogs swim? (**Yes**).
 2. What is a Badgers favourite food? (**Earthworms**).
 3. What family does the fox come from? (**The dog family**).
 4. What is Britain's only spiny mammal? (**The hedgehog**).
 5. How many spines does an adult hedgehog have? (**Around 5,000**).
 6. What time do hedgehogs come out? (**At night**).
-

1. Where do moles live? (**In a fortress**).
2. Are woodlice related to crabs? (**Yes**).
3. How many legs does a woodlouse have? (**fourteen**).
4. Where is an insects skeleton? (**On the outside**).
5. How do woodlice breathe? (**Through gills**).
6. Do woodlice shed their skin? (**Yes**).



Games Questions

1. Are moles blind? (**No**).
 2. What is a group of badgers called? (**A Clan**).
 3. What do wasps make their nests from? (**Wood, Paper**).
 4. Can nettles be eaten when cooked? (**Yes**).
 5. What's a hares home called? (**A form**).
 6. When does an owl go to sleep? (**During the day**).
-

1. Does a frog hibernate? (**Yes**).
2. How many types of bats are there in Britain? (**sixteen**).
3. What food do bats eat? (**Moths**).
4. Are Red squirrels colour-blind? (**Yes**).
5. What is the seed of an oak tree called? (**An Acorn**).
6. What is a female fox called? (**A vixen**).



Games Questions

1. When do owls catch food? (**At night**).
 2. What is a pike? (**A fish**).
 3. What is a wild rose's fruit called? (**A rose hip**).
 4. What's the name of a small wild apple? (**A crab apple**).
 5. What do otters eat? (**Fish**).
 6. What is a polecat? (**A ferret**).
-

1. Where will you find a carp? (**In fresh water**).
2. How many horns does a female deer have? (**None**).
3. What is a flock of crows called? (**a murder**)
4. Do spiders taste with their feet? (**Yes**).
5. How do spiders catch insects? (**In a web**).
6. How many eyes does a spider have? (**8**).



Games Questions

1. What is a baby spider called? (A spiderling).
 2. What is a group of birds called? (A flock)
 3. What is a group of fish called? (A Shoal)
 4. What is a group of bees called? (A Swarm)
 5. What is a group of deer called? (A Herd)
 6. What is the only animal that has feathers? (a bird)
-

1. Do all birds fly? (No)
2. What is a barnacle? (a mollusc)
3. What is a pond skater? (a water insect)
4. Where does a pond skater live? (On the top of the pond)
5. Where does a water boat man live? (under the pond water)
6. Does a spider lay eggs? (yes)



Games Questions

1. Is a slug related to the octopus? (**Yes**).
 2. Where do conkers come from? (**Horse chestnut trees**)
 3. What is the correct name for a conker? (**A horse chestnut**)
 4. Is Holly prickly? (**yes**).
 5. Is Holly an evergreen? (**Yes**)
 6. Hawthorn has white blossom and red berries? (**Yes**)
-
1. What colours is a magpie? (**Black & white**)
 2. What is a coot? (**A water bird**)
 3. What is a foxglove? (**a woodland plant**)
 4. Does Willow bark contain Aspirin? (**yes**)
 5. Do spiders have waists? (**yes**)
 6. What do plants make from water, sun light and carbon dioxide gas?
(Sugar)



Games Questions

1. What is a herbivore? (**An animal that eats plants**)
 2. What is a carnivore? (**An animal that eats other animals**)
 3. What is an omnivore? (**an animal that eats both animals and plants**)
 4. What is a stinkhorn? (**A Fungus**)
 5. What is a puffball? (**A Fungus**)
 6. What is a Red admiral? (**A butterfly**)
-

1. Do most butterflies hibernate? (**yes**)
2. When do leaves fall off the trees? (**in autumn**)
3. When do the trees get their leaves back? (**in spring**)
4. How many seasons are there in a year? (**four**)
5. Which tree has helicopter seeds? (**sycamore**)
6. What tree has black buds (**ASH**)



Games Questions

1. What tree is an anagram of CHEBE (**BEECH**)
 2. What tree twigs are used for Besom Brooms (**BIRCH**)
 3. What tree is an anagram of DREEL (**ELDER**)
 4. What tree is used to make charcoal (**HAZEL**)
 5. What tree were Nelsons ships built from (**OAK**)
 6. Rowan berries are used to make a jelly eaten with venison (**yes**)
-

1. What bush was the original Christmas tree (**HOLLY**)
2. What climbing evergreen do wrens nest in. (**IVY**)
3. How do plants breathe? (**Through holes in leaves**).
4. How many petals does a wild rose have? (**Five**).
5. What is the smallest meat-eating animal in Britain? (**The Weasel**).
6. What is a Holly Blue? (**A Butterfly**).



Games Questions

1. What do bats eat? (**Moths**)
 2. What are fungi? (**mushrooms & Toadstools**)
 3. How do plants drink water? (**through their roots**)
 4. What is a four spotted chaser? (**a dragonfly**)
 5. How many species of dragonfly are there in Britain? (**forty five**)
 6. Are weasels and stoats carnivores? (**yes**)
-

1. Do dragonflies bite? (**no**)
2. Do dragonflies sting? (**no**)
3. Do dragonflies have antennae? (**yes**)
4. What is the folk name for Damselflies? (**Devils darning needles**)
5. How long does a mayfly live for? (**a few days**)
6. How many legs does a spider have? (**eight**)



Games Questions

1. What is a backswimmer? (a beetle)
 2. What is another name for a crane fly? (daddy long legs)
 3. What is the maximum length of an earthworm? (25cm)
 4. What is a speckled wood? (a butterfly)
 5. Is a bat a mammal? (yes)
 6. How many species of bat are there in Britain? (sixteen)
-

1. What is a Mallard? (a duck)
2. What is in an Oak Apple? (A wasp grub)
3. What is a gatekeeper? (a butterfly)
4. Are butterflies invertebrates? (yes)
5. What colour are ivy berries? (black)
6. What is Britain's smallest mammal? (Pygmy shrew)



Games Questions

1. Where does a dormouse live? (**Hazel Coppice**)
 2. Are bats nocturnal? (**yes**)
 3. Do badgers have claws? (**yes**)
 4. Does an Adult Mayfly have a mouth? (**No**)
 5. What is a Tench? (**a fish**)
 6. What is a Holly Blue? (**a butterfly**)
-
1. What colour are the spots on a speckled wood butterfly? (**yellow**)
 2. If you find chains of spawn in a pond who laid it? (**A toad**)
 3. Ramsons is also known as wild? (**Garlick**)
 4. Does a hedgehog have a tail? (**yes**)
 5. What is the start of a food chain? (**Sun**)
 6. What colour is a fly agaric fungi? (**red & White**)